

SALES DRAWING

SALES DRAWING

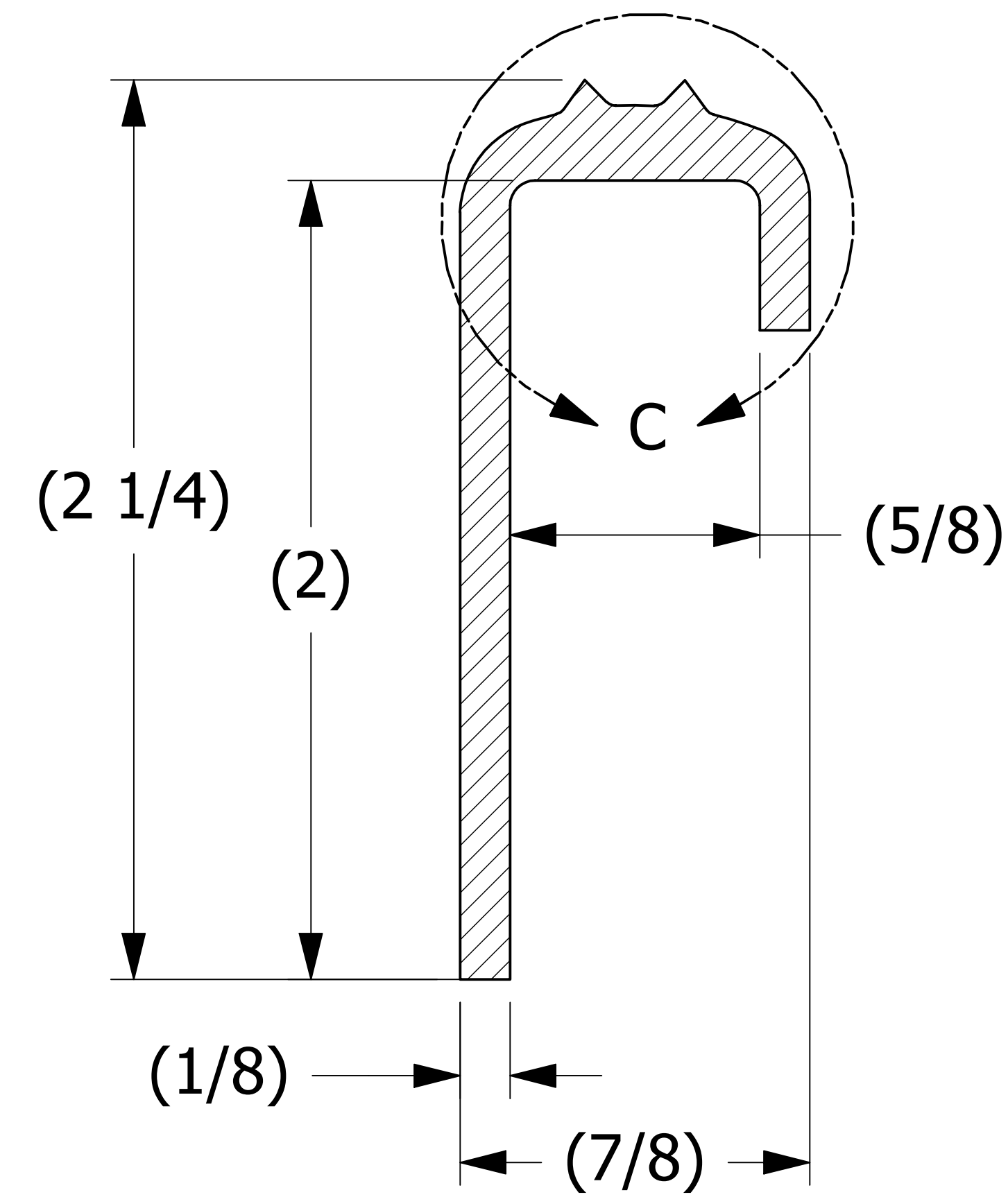

SECTION B-B
SCALE 3 : 1

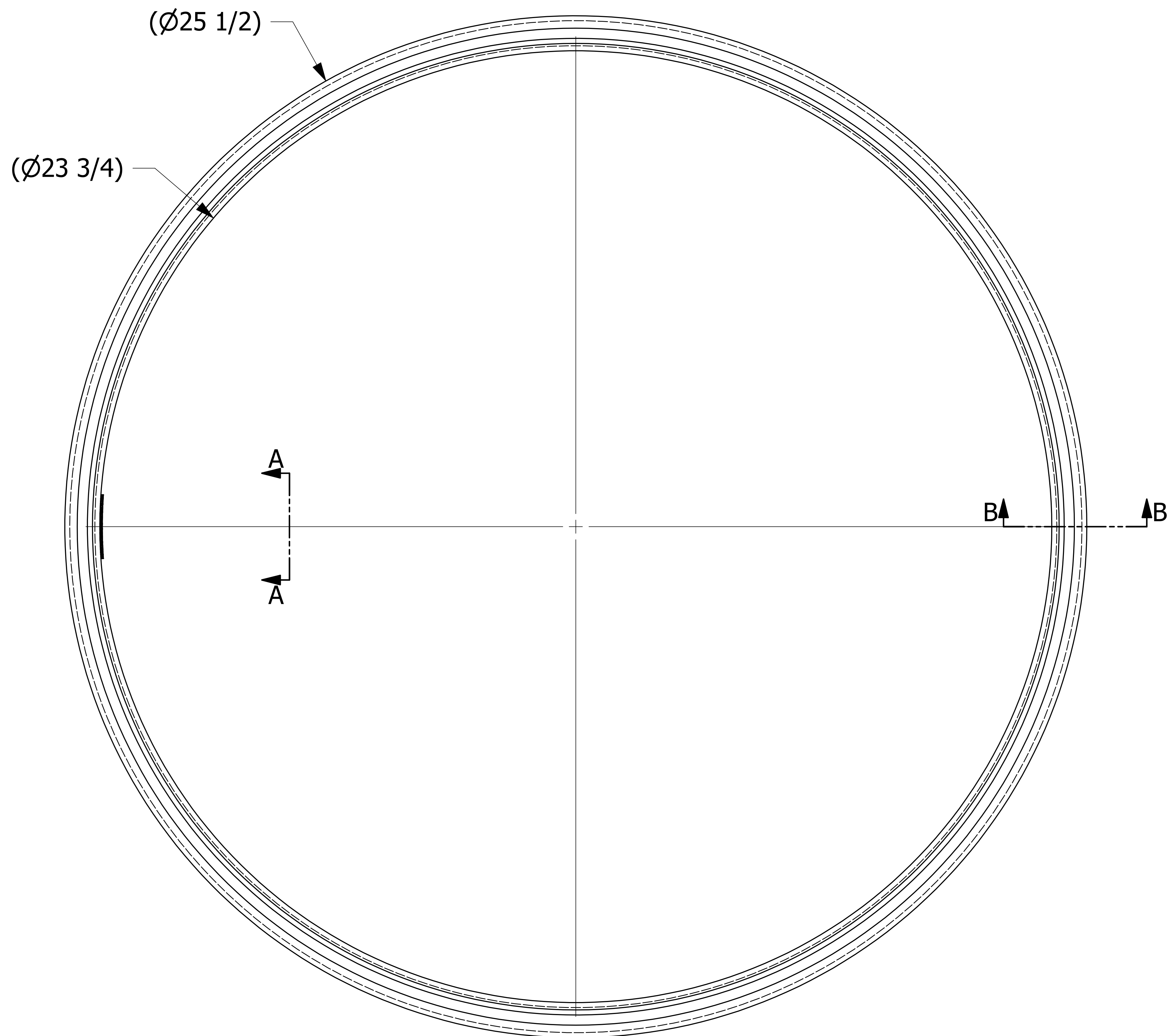
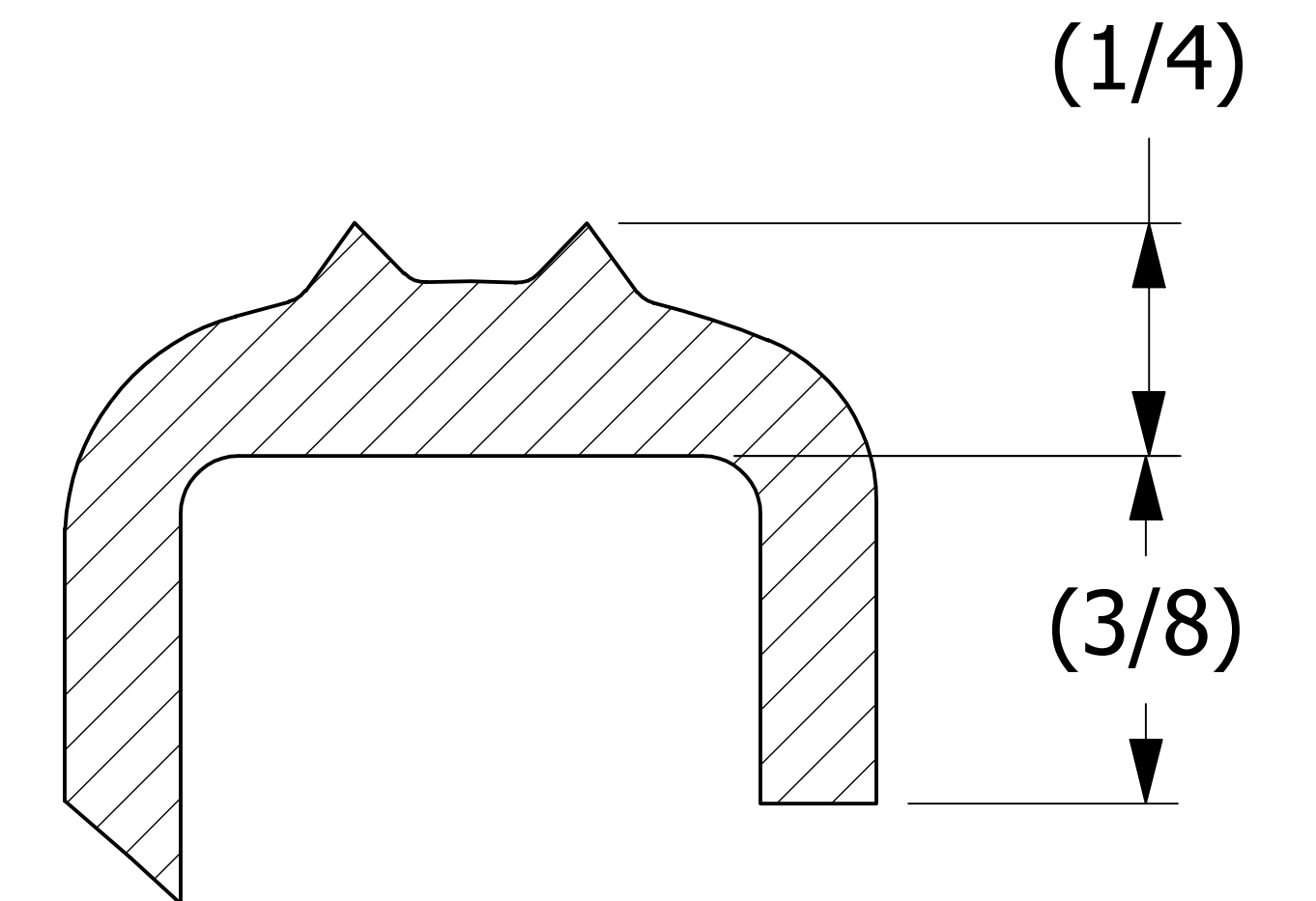

DETAIL C
SCALE 5 : 1



SECTION A-A
SCALE 3 : 1

C	WEB	1-21-16	UPDATED PATENT INFO AND CURRENT CAD STANDARDS DRAWING WAS D SIZE
B	MRC	10-31-97	PATENT NO. PREVIOUSLY NOT AVAILABLE
A	ACC	10-6-97	DUROMETER WAS 70 ± 5
REV	BY	DATE	DESCRIPTION

UNLESS OTHERWISE SPECIFIED DIMENSIONAL TOLERANCES FRACTIONAL: ±1/16 X.XX: ±.03 X.XXX: ±.015 ANGULAR: ±1° DEBURR ALL SHARP EDGES. ALL MACHINED SURFACES TO HAVE A 125 RMS FINISH UNLESS NOTED OTHERWISE.	DRAWN BY:	ACC	<div><div></div><div>SALCO PRODUCTS, INC.</div></div>		
	CHECKED BY:				
	PROTOTYPE BY:	ACC	MATERIAL: WHITE FDA NITRILE DURO 80±5 SHORE A		
	PROTOTYPE DATE:				
	APPROVED FOR PRODUCTION BY:	ACC	DRAWING #: E8407 PART #: TC24NGN		
THIRD ANGLE PROJECTION	PRODUCTION DATE:	10/6/1997			

THIS PRINT, PROPERTY OF SALCO PRODUCTS INC, CONTAINS PROPRIETARY INFORMATION AND MUST NOT BE COPIED, REPRODUCED, OR USED DETRIMENTALLY TO OUR INTERESTS